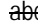
 Easy to grow

 More Difficult

 Very difficult/impossible to grow in this yard

 Planted this year

 ~~abe~~ Died out over winter

H E R B S

Plant name	Origin/ botanical/ varietal names	Planting date	Fertilizing dates	Last season status/notes
Bay leaf	Laurel	May	3/24	Slow growing but did well in winter
Basil (African Blue)		May 2012	3/8	Got a bit woody and leaves lost their greenness slightly.
Basil (Italian)	Genovese	4/7	4/7	
Basil (Purple)	Red rubin	4/7	4/7	
Basil (Lemon)		3/24	3/24	
Basil (Thai)		3/24	3/24	
Basil (Pesto)	Perpetua	3/24	3/24	
Sweet Thai Basil		April		Died in winter
Lemon Bergamot	Monarda citriodora	April		Died in winter
Chervil		4/7	4/7	
Chives		3/8	3/8	Died out by October
Chives (garlic)		3/24	3/24	
Chamomile	Reman	3/24	3/24	
Curry leaf plant	Kadipatta	Aug 2012	3/24	Struggled through winter but did not die.
Dill	Fernleaf (anethum graveolens)	3/8	3/8	Died out by October

Plant name	Origin/ botanical/ varietal names	Planting date	Fertilizing dates	Last season status/notes
Dill	Hercules	3/24	3/24	
Oregano	Italian	2012	3/24	Very scant leaves in winter
Oregano	Greek	3/22	3/22	-
Marjoram	Origanum majorana	2011	3/8	True perennial. Thrived thru' winter
Mint (California)	Yerba buena Indian mint	May 2012	3/8	April 2012
Mint (Persian)		2011	3/8	Did quite well
Mint (English)	Kentucky colonial	April	3/8	Lost leaves but survived
Mint (Orange)		3/24	3/24	
Mint (Chocolate)		3/24	3/24	
Mint (Apple)		3/24	3/24	
Myrtle	Grecian	3/24	3/24	
Rosemary	Barbecue	April 2012	3/8	Thrived
Thyme (Lemon)	Variegated	April 2012	3/8	Lost a few leaves, but fine
Thyme de Provence		April 2012	3/8	Lost a few leaves, but fine
Thyme (Big Leaf)		April 2012	3/8	Lost a few leaves, but fine
Parsley	Flat Italian	4/7	4/7	
Parsley	Curly leaf 'Aphrodite'	4/7	4/7	
<del>Common sage</del>	<del>Salvia officinalis</del>	<del>2008</del>		

Plant name	Origin/ botanical/ varietal names	Planting date	Fertilizing dates	Last season status/notes
Sage	Common	3/24	3/24	
Sage	Bergarten	3/24	3/24	
Sage	Black Island	3/24	3/24	
Tarragon (French)	Artemisia dracunculus	3/24	3/24	
Lemon Verbena		2011	3/8	Slowly recovering 4/8

V E G E T A B L E S

Plant	Origin/ botanical/ varietal names	Planting date	Fertilizing dates	Last season status/notes
<del>Cherry tomato</del>	<del>Black cherry</del>	<del>March</del>		<del>Flowered but did not fruit. Second year growing tomatoes. Do not grow in this yard.</del>
English peas	Piccolo Provenzale	March		Did well but very susceptible to midew. Good harvest. Died
Kale	Russian red, winter or, deep red curly redbor	March	3/24	Survived winter. First to flower in spring.
Kale	Rainbow dinosaur	March	3/24	Survived winter. First to flower in spring.
Swiss Chard	Bright lights	May	3/24	Survived winter
Squash Zucchini		May		About 10 zukes from small pot. Died.
Persian cucumbers	Bolt alpha (aka-Mediterranean cuke)	May		About 10 cukes from small pot. Died.
Brocollini		March		Died out end of summer. Not prolific. Perhaps pot was too small

Plant	Origin/ botanical/ varietal names	Planting date	Fertilizing dates	Last season status/notes
Spring onions	Cipolotto di Mazzi	2011	3/23	Going strong. Survives winter easy.
Serrano peppers		2011		Flowered. Fruit underdeveloped
Arugula	Sylvetta del olio	2011	3/24	Planted in ground. Thriving.
Celery	Giant pascal	2011	3/23	Going strong
Sweet peppers	Cajun bells	April		
Leek	Bleu de solaise	3/24	3/24	
Perpetual spinach				Died out in winter

F L O W E R S

Plant	Origin/ botanical/ varietal names	Planting date	Fertilizing dates	Last season status/notes
Hydrangea		2011	3/23	Buds sprang to leaves in early March. Just one flower last year.
Fuchsia	Dollar princess	2010	3/23	Leaves slowly back. Fewer flowers last year. No flowers so far 4/8
Jasmine (Arabian)	Jasminum sambac	May	3/23	Plant healthy. Slow growing. No flowers yet.
Zinnia	Profusion cherry (Z.-Angustifolia)	May		Died over winter
Dahlia		April		Died over winter
Dahlia	Aspen chips	4/7		Planted bulbs on 4/7
Dahlia	Cross-field ebony	4/7		Planted bulbs on 4/7

Plant	Origin/ botanical/ varietal names	Planting date	Fertilizing dates	Last season status/notes
Daisy		April	3/23	Scrappy plant. Flowers throughout.
Marigold	Durango red	May		Died over fall. flowered well
Sweet pea	Lathyrus odoratus 'Lord Nelson'	March		Flowered well. Should have dead headed. Died over summer.
Sweet pea	Sicilian	3/24	3/24	
Carnation	Dianthus caryophyllus	April		Flowered well. Died over winter.
Gerbera daisy		May	3/24	Few flowers. Died over winter.
Tea rose		2011		Cannot be killed. Very sturdy.
Rose:	hot cocoa	February	3/24	Aphid and caterpillar problems, but great if scant, blooms over summer. Mostly healthy.
Rose:	Cherry parfait		3/24	
Rose	Sugar moon		3/24	
Rose:	royal amethyst	February	3/24	In ground. Mulched. Aphid and caterpillar problems, nominal scant, blooms over summer. Not healthy. Had to be significantly pruned back.
Rose:	Classic woman	February	3/24	In ground. Mulched. Aphid and caterpillar problems, nominal scant, blooms over summer. Not healthy. Had to be significantly pruned back.
Lavender	Lavendula angustifolia Vera English	2011/may	3/24	Thriving.
Hibiscus	Hibiscus rosa-sinensis	May	3/24	Slow growing. Flowers well. Thought it died over winter but bouncing back.
Silver dollar eucalyptus	Eucalyptus cinerea	April	3/23	Slow growing
Rose geranium		Sept 2012	3/23	Thrived and flowered well.
Lily	Eyeliner	3/23	3/23	Currently coming breaking through soil 4/8

Plant	Origin/ botanical/ varietal names	Planting date	Fertilizing dates	Last season status/notes
Dahlia		4/7		
Dahlia		4/7		
Nasturtium				
Borage				
Sunflower				
Ranunculus	Yellow	3/24	3/24	
Ranunculus	Pink asiatic	4/7	4/7	
Ranunculus	Mache Purple	4/7	4/7	
Alyssum snow crystals				Died over winter.

F R U I T S

Plant	Origin/ botanical/ varietal names	Planting date	Fertilizing dates	Last season status/notes
Strawberries	Mara de bois	2011	3/24	Looks alive. Survived last year.
Lemon	Improved Meyer lemon	4/7	4/7	
Lingonberry	Red pearl	3/24	3/24	
Limes	Seedless key lime	May	3/24	Healthy plant. Flowers. No fruit yet.

Easy to grow
  More Difficult
  Very difficult/impossible to grow in this yard
  Planted this year
 abc Died out over winter

Container garden layout

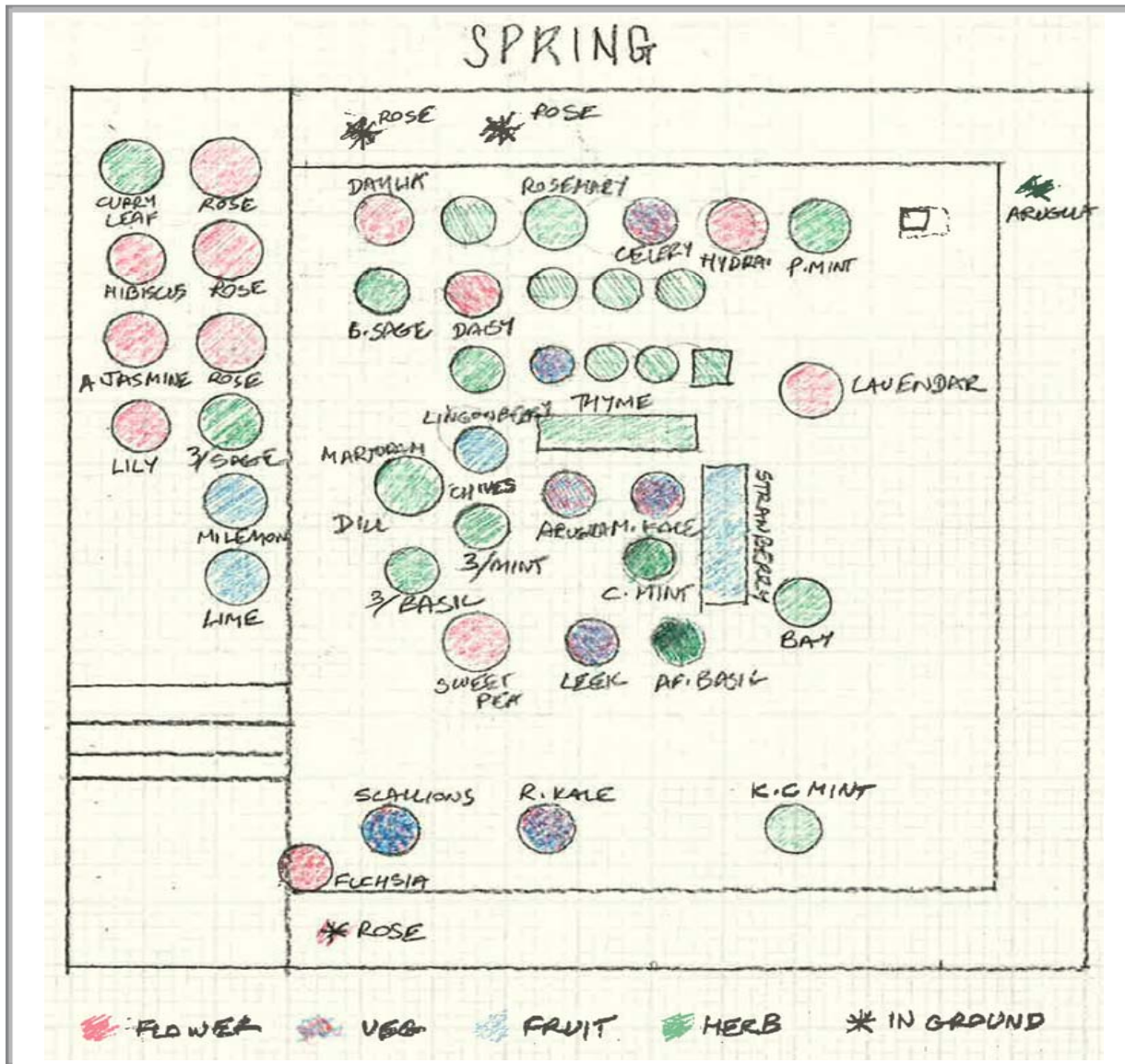

Sources:

Who	Where	What
Flatland flowers	Ferry building	Herbs, veg, edible flowers
Three Bees nursery	Clement st	Material, plants
<u>Sloat</u>	2nd avenue, sloat	Everything
<u>Regan nursery</u>	Fremont	Roses, flowers
<u>Flora Grubb</u>	Dog patch	Till us, succulent, herbs
Hortica	Castro	Herbs, flowers, fruit
Flowercraft farms	Bayshore	Flowers, fruit
SF flower & garden show	San Mateo (end of March)	Hard to find herbs, flowers, fruit
Home depot	Daly city	Everything

References:

<http://www.container-gardening-guide.com/keep-a-garden-journal.html>

<http://www.apartmenttherapy.com/keep-your-green-thumbs-off-the-screen-6-gardening-apps-weekly-smartphone-app-roundup-165833>